

# DAMA

ITALY

## TABLE BLENDER

### INSTRUCTION MANUAL



5

YEARS

WARRANTY



## ***DESCRIPTION:***

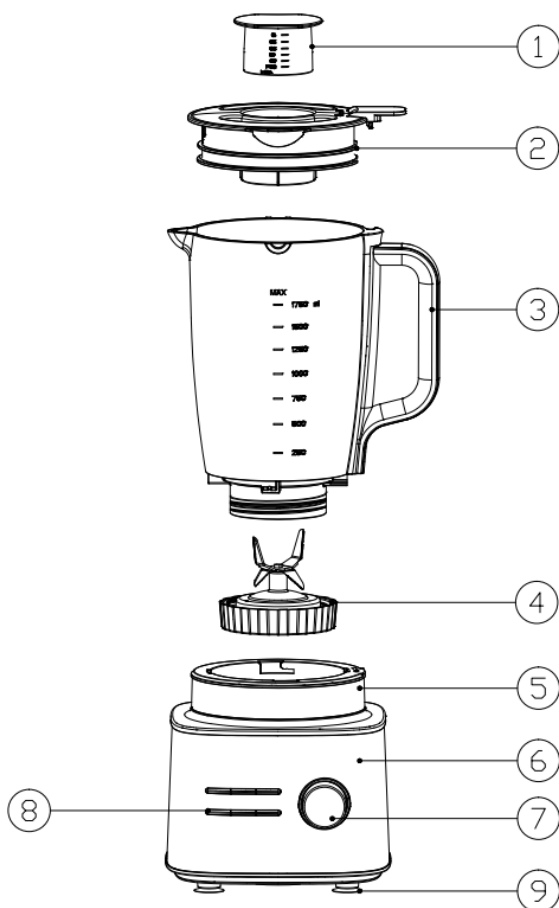

<b>1. Measuring cup</b>	<b>7. Knob</b>
<b>2. Lid</b>	<b>8. Button</b>
<b>3. 1.5L Glass bowl</b>	<b>9. Rubber feet</b>
<b>4. Blade</b>	<b>10.S.S bowl</b>
<b>5. Upper s.s. body</b>	
<b>6. s.s. body</b>	

# ***Important Safeguards***



When using electrical appliances, to reduce the risk of fire, electric shock, and/or injury to persons, basic safety precautions should always be followed, including the following:

You should respect the following safety warnings:

**⚠ WARNING:** The blades of the knife are extremely sharp. Handle them with caution.

Read all instructions carefully.

1. To protect against electric shock, do not place cord, plug or appliance in water or other liquid.
2. Close supervision is necessary when any appliance is used by or near children.
3. This appliance is not intended for use by persons (including children) with reduced physical, sensory or mental capabilities, or lack of experience and knowledge, unless instructions concerning use of the appliance by a person responsible for their safety.
4. Unplug from outlet when not in use and before cleaning.
5. Do not operate any appliance with a damaged cord or plug, in case of appliance malfunctions or if the appliance has been damaged in any manner.
6. The use of accessory attachments not recommended by manufacturer may cause malfunctions.
7. Do not use outdoors.
8. Do not let cord hang over edge of table or counter, or touch hot surfaces.
9. Do not place the appliance on or near hot gas or electric burner, or in a heated oven.

10. This product has been designed for domestic use only. Any commercial use, inappropriate use or failure to comply with the instructions, the manufacturer accepts no responsibility and guarantee is no more valid.
11. Do not use your food processor if any part is broken.
12. Do not put the appliance, the power cord or the plug into water or any other liquid.
13. Make sure that the cover is securely locked in place before operating the appliance.
14. Never place ingredients in the container by hand and while the appliance is in use. Always use the food pusher.
15. The blade and discs are sharp. Handle carefully. Store out of reach of children.
16. If the power cord or the plug are damaged, do not use your appliance.
17. For your own safety, please use only the original accessories and spare parts which are suitable for your appliance.
18. Never remove the lid until the knife has stopped completely.
19. This appliance is designed to process small quantities. Do not exceed the quantities indicated in these instructions for use.
20. Do not use this appliance to mix glutinous food or substance.
21. Do not use appliance for other than intended use.
- 22.** For your safety, this appliance conforms to the appliance standards, regulations and directives of Low Voltage, Electromagnetic Compatibility, Environment, etc.

## ***Using Your Appliance***

Before first use, clean the various parts of the appliance.



## Attention:

- When the device is powered on, the start knob will flash with red. After the glass cup is fixed, the red light will stop flashing and the knob will turn to "ON" to light up white.

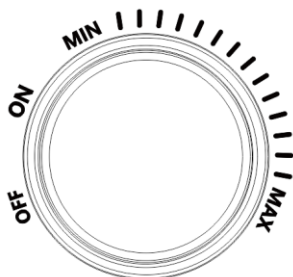

- The start knob allows you to use a variety of speeds from minimum power (min) to maximum power (max).
  - The start knob has 2 function buttons for your reference.
- \*Power off function: OFF
- \*Power on function: ON

## Button function



- When you use the function button to process your food, you can turn the knob "ON" and press the button as needed.

- **Working capacity is 1.5L.**

## Using the glass jar

- Pour in the ingredients and cover the glass bowl (Fig. 1), and then place the glass bowl into the host (Fig. 2), turn clockwise (Fig. 3). Lift the glass bowl to check it is locking whether or not.
- Plug in the appliance and rotate the start knob to which speed you need.
- At the end of preparation, rotate the start knob to position “OFF”, unplug the appliance and wait until the blades come to a complete stop.
- Remove the glass bowl and take off the lid, then pour out the ingredients.

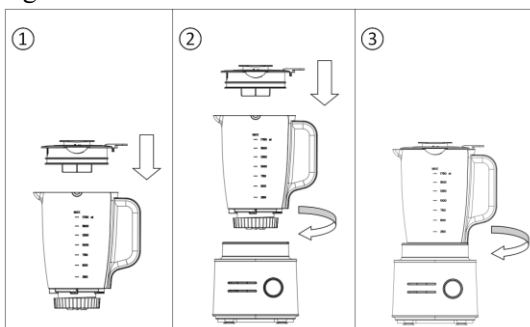

## Blending With function button

- **Smoothie** 

When you use the smoothie button to process food, you need to turn the knob clockwise to the position of “ON”, the indicator light is red, and then press the smoothie button, the machine will start the program and stop after running at full speed for 60 seconds (the indicator light is always white when working, the indicator light is

always red when stopping work, and the red blinks when the cup is not placed properly).

### •Ice & Crush

When you use the ice crush button to process food, you need to turn the knob clockwise to the position “ON” where the indicator light is red, and then press the ice crush button, the machine will start the program, open 3S to stop 4S, open 2S to stop 2S, open 3S to stop 3S, open 4S to stop 3S, open 5S to stop 3S, open 6S to stop 4S, open 42, and the total time is 60S(the indicator light is always white when working, the indicator light is always red when stopping work, and the red blinks when the cup is not placed properly).

### •Veg&Fruit

When you use the vegetable and fruit button to process food, you need to turn the knob clockwise to the position “ON” where the indicator light is red, and then press the vegetable and fruit button, the machine will start the program, open 2S and stop 2S, open 4 cycles, continue to work for 40S and then stop, the total time of the whole process is 56S(the indicator light is always white when working, the indicator light is always red when stopping work, and the red blinks when the cup is not placed properly).

### •Puree

When you use the vegetable pureed button to process food, you need to turn the knob clockwise to the “ON” position, the indicator light is red, and then press the vegetable pureed button, the machine will start the program, open 2S and stop 2S, open 10 cycles, continue to work

for 30S and then stop, the total time of the whole process is 70S(the indicator light is always white when working, the indicator light is always red when stopping work, and the red blinks when the cup is not placed properly).

### •Ice Cream

When you use the ice cream button to process food, you need to turn the knob clockwise to the position “ON” where the indicator light is red, and then press the ice cream button, the machine will start the program, open 2S and stop 3S, after 10 cycles, continue to work for 20S and then stop; Open for 1S and stop for 2S, after 5 cycles, continue working for 20S and then stop.(the indicator light is always white when working, the indicator light is always red when stopping work, and the red blinks when the cup is not placed properly).

### •Clean

When you use the clean button to process food, you need to turn the knob clockwise to the “ON” position, the indicator light is red, and then press the clean button, the machine will start the program, open 3S stop 3S, 6 cycles.(the indicator light is always white when working, the indicator light is always red when stopping work, and the red blinks when the cup is not placed properly).

### **With Stainless Steel Bowl**

- **Pour in the ingredients and locking the buckles of the lid and the stainless steel bowl, and then press the lid hear the security locks snap. Lift the lid to check it is locking whether or not. Place the stainless steel bowl into the host and turn clockwise.**
- **Plug in the appliance and rotate the start knob to which speed you need.**
- **At the end of preparation, rotate the start knob to position OFF, unplug the appliance and wait until the blades come to a complete stop.**
- **Remove the stainless steel bowl and take off the lid, then pour out the ingredients.**

## **Baby Food**

### **To mix or blend cooked food:**

- **Chop the food into small pieces, add some broth (meat or vegetables) and mix the ingredients with pulses. To blend the mixed food, rotate the start knob till you reach the desired result.**

### **For fruit preserves:**

- **Chop the fruits into small pieces, add some milk, water or juice and mix the ingredients with pulses. To blend the fruits, rotate the start knob till you reach the desired result.**



**CAUTION:**

**Note:** Temperature control safety protection device. When the use is abnormal, the temperature control will automatically disconnect to maintain safety. You need to unplug the power and wait patiently for an hour before continuing to use the machine. The temperature drops.



**CAUTION:** Maximum time of processing should not exceed 1

minute continuous use. In order to achieve below processing times, use the appliance with pulses and intermediate 5 second pauses.



**CAUTION: DO NOT OPERATE THE UNIT WHEN EMPTY.**



**CAUTION: DO NOT PUT HOT INGREDIENTS INTO THE BOWL. BEFORE FOOD PREPARATION, ALLOW FOOD TO COOL DOWN FOR A FEW MINUTES.**



**CAUTION: Before you eat or serve blended food, please always check for ingredients that might have not been blended adequately.**

**GENERAL:**

For better results: please make sure that the quantity of ingredients fully covers the blade while chopping solid food.

### **Care and Cleaning**

- Always unplug the appliance first.
- Only use a damp sponge to clean the motor unit. Never place it in water, or under running water.

## ***TECHNICAL SPECIFICATION***

Voltage: **220-240V~50/60Hz**

Rated Power: **1800W**

**Class II**

